



Model

AB-34PSS

3/4" Impact Wrench

Offers one of the industry's highest power-to-weight ratios. Featuring a stainless steel hammer case and a twin hammer design for increased durability. Constructed with non-corrosive materials for prolonged field life. 100% Made in the USA.

Drive	3/4" Dual Retainer
Max Torque (Forward)	1800 ft-lbs
Max Torque (Reverse).....	2000 ft-lbs
Length.....	9"
Weight.....	13.5 lbs
Air Inlet Thread	3/8"
Rec'd Hose Size	1/2"
Avg. Air Consumption	58 cfm

★ Ask Your Sales Representative About the Service and Support Coverage of Your 2-YEAR LIMITED WARRANTY For This Tool

On the Job? Get Help Now!
(844) 486-7783
www.americanbolting.com



Model

AB-1 PSS

1" Impact Wrench

Offers one of the industry's highest power-to-weight ratios. Featuring a stainless steel hammer case and a twin hammer design for increased durability. Constructed with non-corrosive materials for prolonged field life. 100% Made in the USA.

Drive	1" Dual Retainer
Max Torque (Forward)	1800 ft-lbs
Max Torque (Reverse).....	2000 ft-lbs
Length.....	9"
Weight.....	13.5 lbs
Air Inlet Thread	3/8"
Rec'd Hose Size	1/2"
Avg. Air Consumption	58 cfm

★ Ask Your Sales Representative About the Service and Support Coverage of Your 2-YEAR LIMITED WARRANTY For This Tool

On the Job? Get Help Now!
(844) 486-7783
www.americanbolting.com

AB-34PSS 3/4" Pistol Impact AB-1PSS 1" Pistol Impact

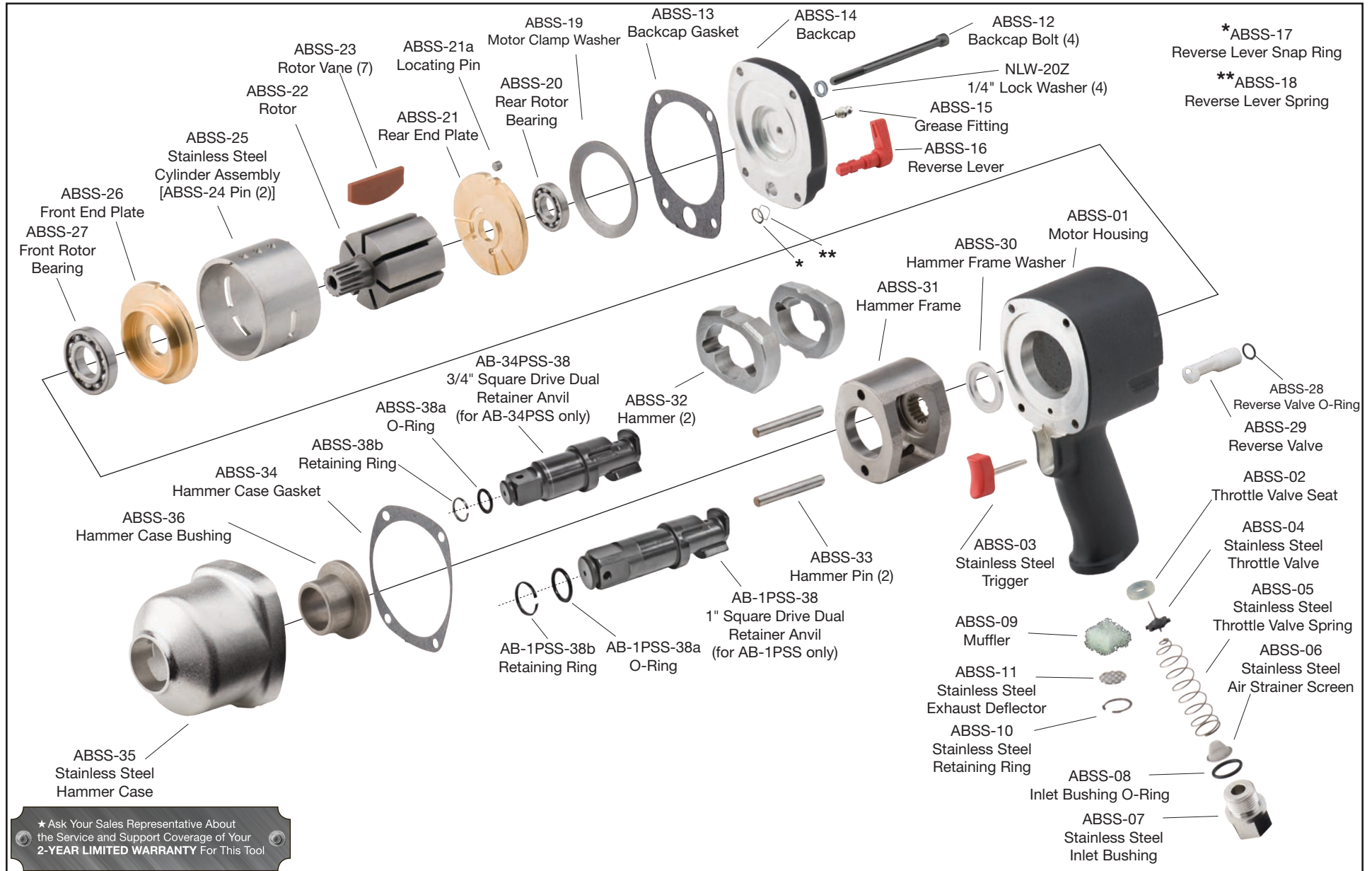

★ Ask Your Sales Representative About
 the Service and Support Coverage of Your
2-YEAR LIMITED WARRANTY For This Tool

AB-1PSS

1" Impact



★ Ask Your Sales Representative About the Service and Support Coverage of Your 2-YEAR LIMITED WARRANTY For This Tool

★ **AB-34PSS** 3/4" Model also available

FEATURES:

- 1 All the Power of a 1" Impact in the Compact Size of a Traditional 3/4" Class Pistol Grip Tool.
- 2 2000 Ft-lbs REV. Torque.
- 3 1800 Ft-lbs FWD. Torque.
- 4 Low Air Consumption at 58 CFM.
- 5 Weighs Only 13.5 Lbs.
- 6 300 Series Stainless Steel Hammer Case Housing and Throttle Components.
- 7 2 Options for Anvil: 3/4" Dual Retainer Anvil, 1" Dual Retainer Anvil.

The AB-SS Series Impact offers the highest power to weight ratio in a 3/4" impact. Featuring Stainless Steel hammer case and Throttle components for use in corrosive environments. The inevitable water and debris that is found in compressed air systems is no match for the stainless steel throttle parts and motor design. The combination of the bronze end plates and stainless steel cylinder prevent the AB-SS series tools from becoming seized after sitting for a nominal period of time with condensation in the motor chamber. The Dual Retainer design on the 3/4" Sq. and 1" Sq. drive anvils provide the operator with socket retainer options. The Twin Hammer design in conjunction with tight motor tolerances delivers extreme torque. Made in the USA.

AB AMERICAN BOLTING

AB-1PSS

1" Impact
MORE FEATURES:

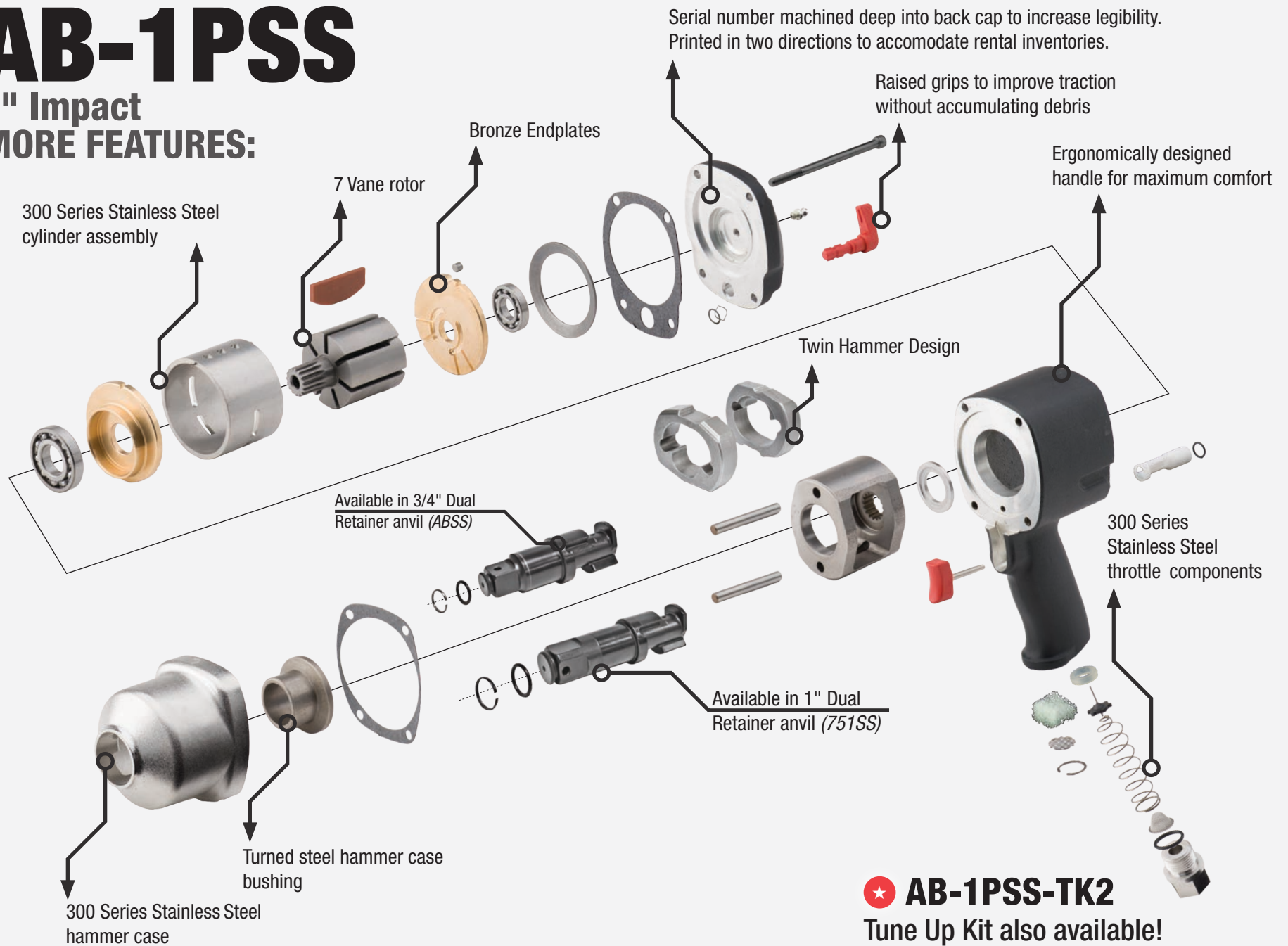

 **AB-1PSS-TK2**
Tune Up Kit also available!